

28 September 2018

Ref: N0207

## Have your say: Hewitt Avenue shared path connection to Pennant Hills Road

Dear resident

In response to community and stakeholder feedback, the design for a replacement shared path at Hewitt Avenue, Wahroonga proposed in Stage 1 of the NorthConnex Urban Design and Landscape Plan (UDLP1) is being modified. The path connects Hewitt Avenue to Pennant Hills Road at the M1 Pacific Motorway intersection, and replaces the previous narrow and steep pathway.

The revised, more visually appealing design will offer the most direct connection between Pennant Hills Road and Hewitt/Havilah avenues and provides less built structure and concrete, a lower profile and additional landscaping. Stairs are provided in addition to the ramps, and the layout improves drainage thereby reducing the risk of flooding. Please see over the page for images of the previous and revised design proposal.

The shared path, which will be owned and maintained by Roads and Maritime Services, is compliant with the Disability and Discrimination Act to enhance connectivity and pedestrian safety, while providing a place making opportunity to improve sustainability. 'Crime Prevention Through Environmental Design' principles were also considered in the design.

Your feedback on the new shared path design is invited by **Friday 12 October, 2018**. Please send your feedback to enquiries@northconnex.com.au or NorthConnex Feedback  
Locked Bag 1001  
West Pennant Hills NSW 2125.

All feedback will be considered and the approved shared path design published at [www.northconnex.com.au](http://www.northconnex.com.au) in the Urban Design and Landscape Plan, Stage 1c.

Work to build the shared path will include installation of services and drainage, reconstruction and resurfacing of the cul-de-sac, and landscaping. Work will generally be carried out during standard construction hours between **7am and 6pm Monday to Friday** and **8am and 1pm on Saturday**, however for the safety of motorists and workers, some of this work may be carried out at night. You will be notified in advance of any night work.

If you have any questions or require more information on the proposed design, please contact us on 1800 997 057 (24 hours), enquiries@northconnex.com.au or visit the NorthConnex Community Information Centre at 118 Yarrara Road, Pennant Hills, open Monday to Wednesday, 9am to 1pm.



Australian Government

**BUILDING OUR FUTURE**



**Transurban**



Hewitt Avenue shared path design proposed in UDLP1



Hewitt Avenue shared path revised design proposal

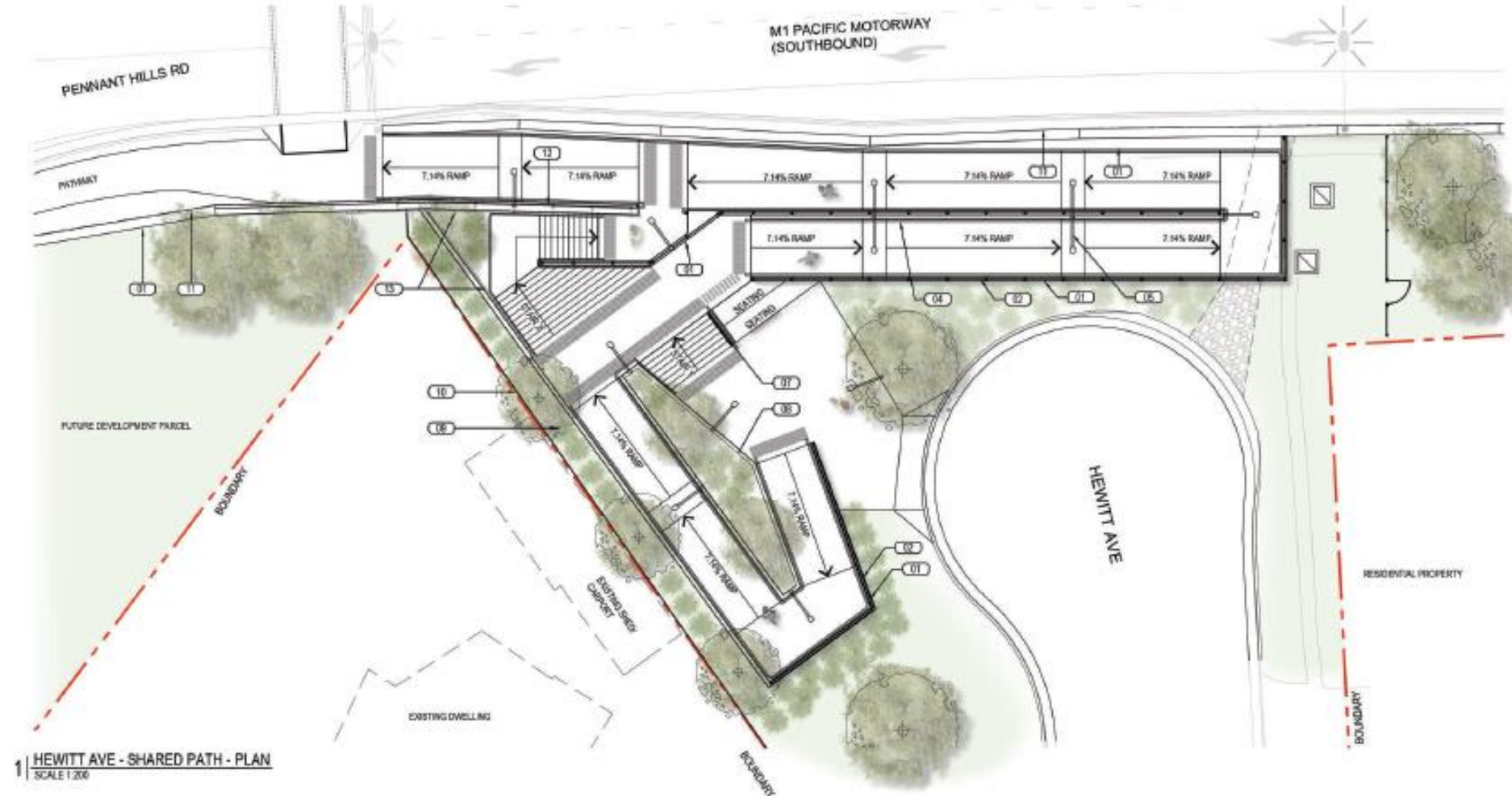

1 | HEWITT AVE - SHARED PATH - PLAN  
SCALE 1:200

LEGEND

- |   |  |                              |
|---|--|------------------------------|
| 01 CONCRETE WALL                                  | 06 STREET LIGHTING                       | 11 ANC NOISE BARRIER         |
| 02 BALUSTRADE WITH TWIN RAIL & MESH INFILL PANELS | 07 CYCLIST WHEEL GROOVE                  | 12 TRANSPARENT NOISE BARRIER |
| 03 PEDESTRIAN HANDRAIL                            | 08 PLANTER BOX WITH LOW LAYING LANDSCAPE | 13 PRIVACY SCREEN            |
| 04 CYCLIST RAIL AND PEDESTRIAN HAND RAIL          | 09 LANDSCAPED AREA                       |                              |
| 05 SHARED PATH LIGHTING                           | 10 BOUNDARY FENCE                        |                              |

PLAN LEGEND

- PROJECT BOUNDARY

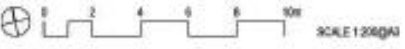

NCX-CM+01-3003-UD-DG-0861  
HEWITT AVENUE SHARED PATH - PLAN

Hewitt Avenue shared path design proposed in UDLP1



